



Axelborg

Bystrategisk Udsyn
Fængslet i Horsens

D. 7. november 2023

Vi bliver ældre

Figur 1. Befolkningsudviklingen fordelt på alder, 2020-2030

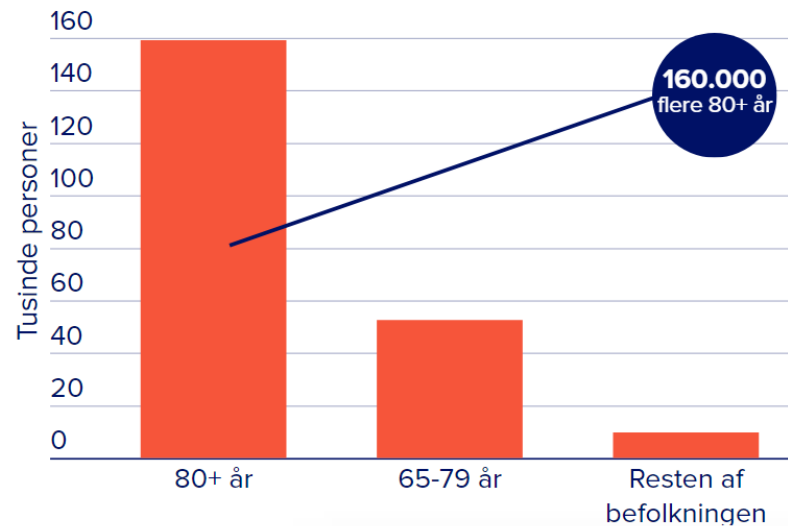

Share

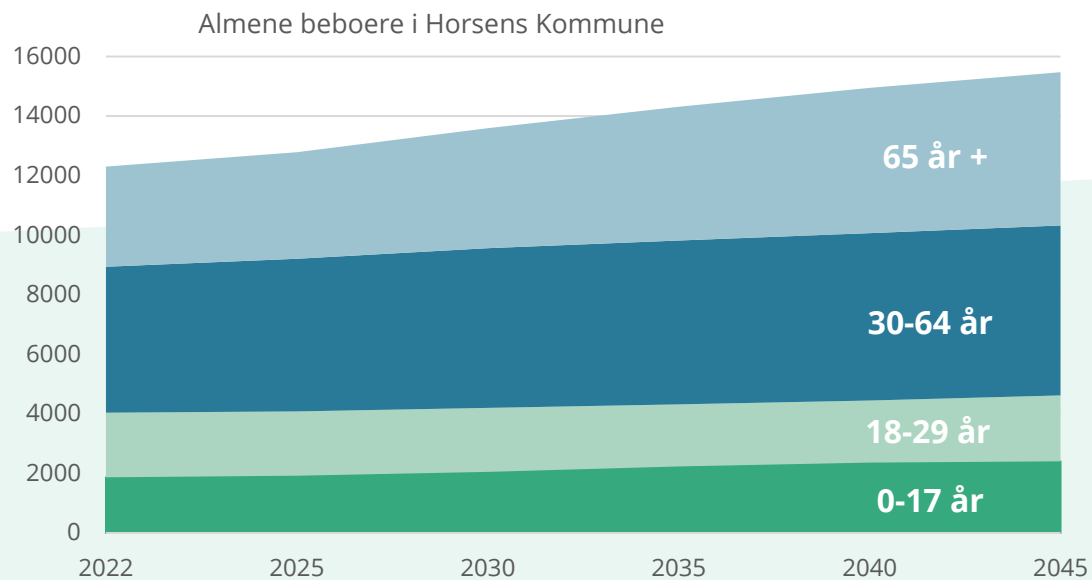

Fremtidsstudiet 2021

Forventninger og drømme, Danskere 50-89 år

- **Livskvalitet:** De nære relationer familie og venner er vigtige.
- **Helbred og sundhed:** Frygten for sygdom og ensomhed er steget. Det er forbundet med presset i sundhedsvæsenet.
- **Boligen:**
 - Med alderen vægter man særligt boligens overskuelighed, adgang til fællesskaber og nærhed til familien højt.
 - Studiet viser også et fald i andelen, som gerne vil blive boende i deres nuværende bolig, hvis de får svært ved at klare sig selv.
- **Ensomhed:** Rammer særligt enlige.



“Det ligner bare 2 vilkårlige streger, men 2023 blev året, hvor flertallet af danskerne bor alene.”

Formidlingschef Kristine Virén, Videncentret Bolius

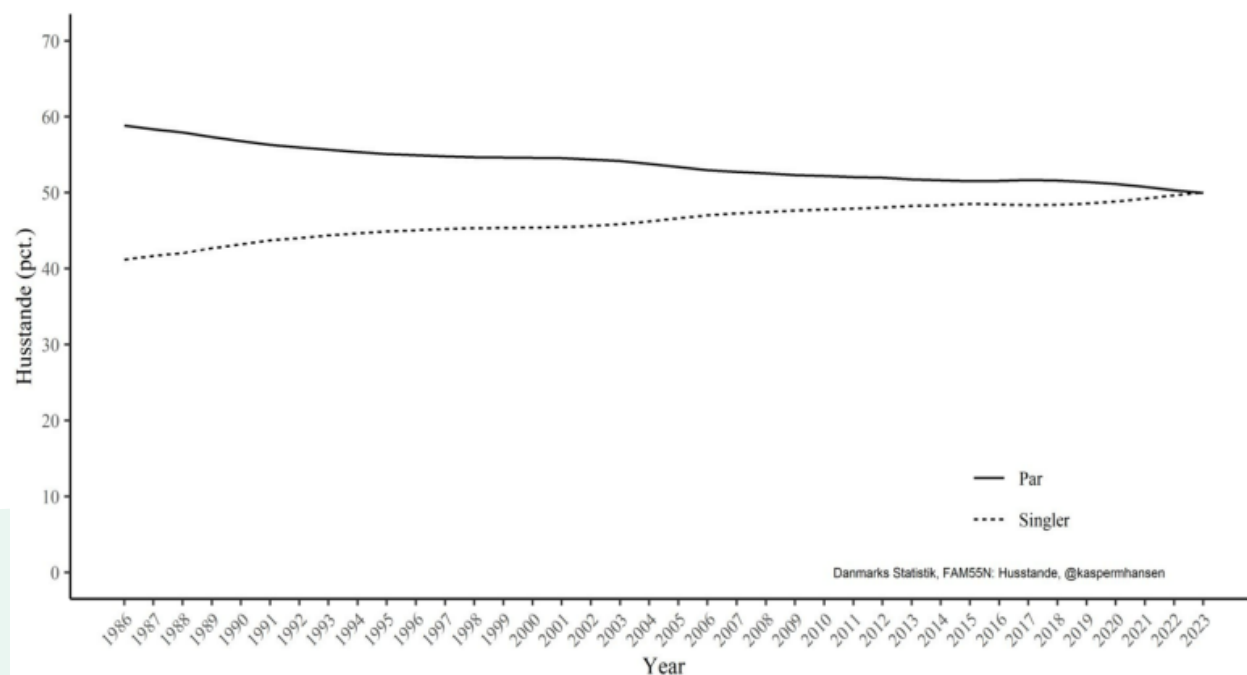

Axelborg



Aging, health & health personel right in our neighborhood!



Institution



Neighborhood

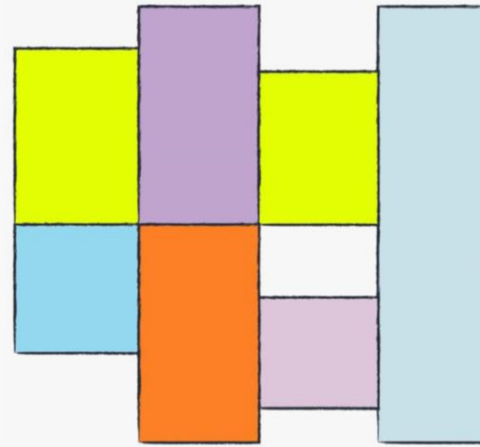
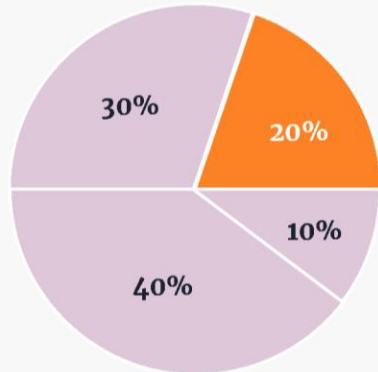

Isolated and introverted

Typical program

- Assisted living short stay
- Assisted living long stay
- Adapted living short stay
- Adapted living long stay
- Healthcare services
- Administration
Technical

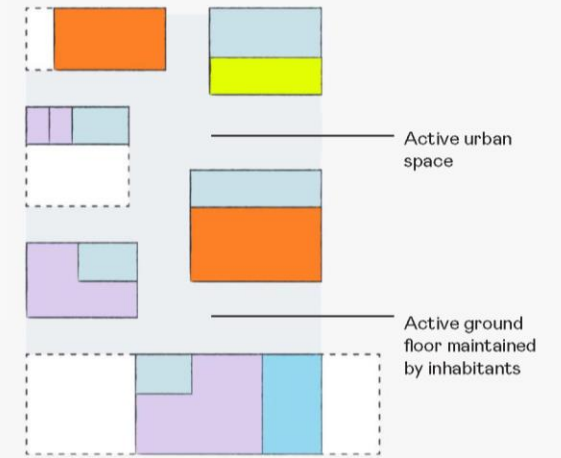

80% of the health determinants happens outside clinical care

From medical care



To preventive care







- General practitioner: can such a doctor get his authorization in Axcelcare?
- Can the Nursing Home Doctor have a practice 1-2 days at Axelcare?
- Preventive home visits – the law on preventive home visits in Denmark has changed. What is required in Axelborg?
- Possibly contact Anne Dorthe Prisak
- A palliative care nurse is desired
- A public health nurse is desired
- Physio/occupational therapy should be available
- A music therapist/psychologist should be available
- VIA Campus should be involved

Mini health hub & community center

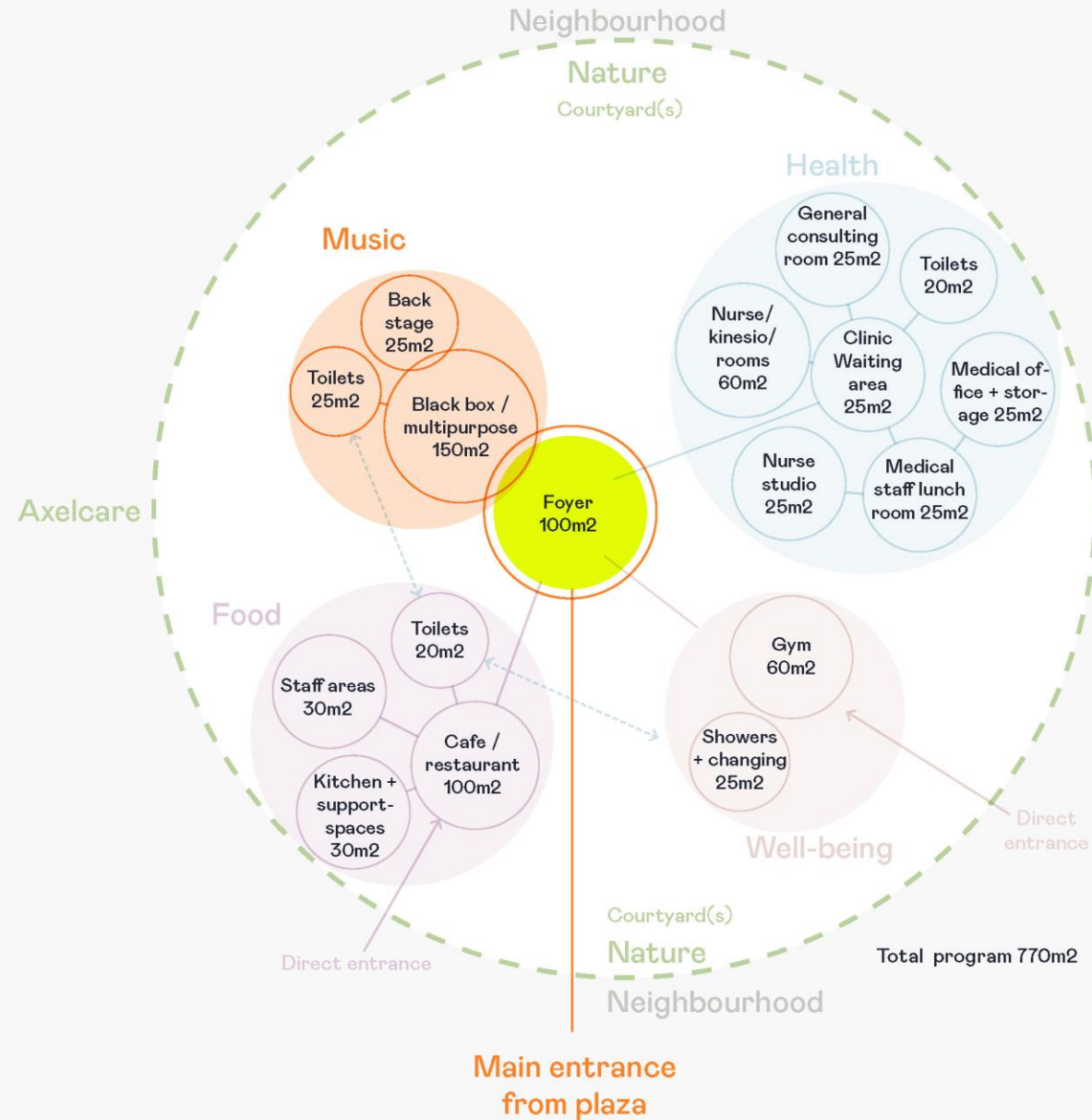

Hvad har Idékonkurrencen betydet for Axelborg?



Neighbourhoods for Generations bragte os fra:

2020

- Klassisk LBF reoveringsstøttesag i Axelborg
- Ansøgning om finansiering af 125 mio. kr.
- Finansieringsskitse: 10 mio. kr.
- Hertil Infrastrukturmidler 32 mio. kr.

2023

- Thinking Outside the B(l)ox & Nursing the Care



- **Reoveringssag som forener interessenter**